

Town Copy

PETITION OF THE NATIONAL GRID
FOR POLE LOCATIONS

TO THE HONORABLE _____ TOWN COUNCIL
OF _____ **EAST GREENWICH** _____ RHODE ISLAND
THE NATIONAL GRID

Respectfully asks permission to locate and maintain poles, wires and fixtures,
including the necessary sustain and protecting fixtures to be owned by your
petitioner along and across the following public ways:

WOODLAND ROAD PROPOSE NEW SOLELY OWNED POLE LOCATION

Wherefore your petitioner request that they be granted locations for and permission to erect and
maintain poles and wires together with such sustaining and protecting fixtures as it may find
necessary, poles to be located in accordance with the plan filed herewith marked: **23988314**

_____ DATED **05/05/2017** _____

Your petitioner agrees to reserve or provide space for one cross arm at
a suitable point on each of said poles for the fire, police, and telephone
wires belonging to the municipality and used by it exclusively for municipal
purposes.

THE NATIONAL GRID

BY John Carey AB

ORDER

The foregoing petition having been read it was voted that the consent of the

_____ for the use of public ways named for the purposes stated in said petition be and it hereby
is granted----work to be done subject to the supervision at

A true copy of the vote at the _____

Adopted _____ and recorded in Records Book# _____ Page# _____

CLERK

Pole & UG Petition/Permit Request Form

City
Town of East Greenwich WR # 23988314
(circle one)

Install 1 pole and anchor SO Poles on Woodland Rd
(quantity) (circle one) (street name)

Remove SO Poles on
(quantity) (circle one) (street name)

Relocate SO Poles on
(quantity) (circle one) (street name)

Beginning at a point approximately feet of the centerline
(distance) (compass heading)
of the intersection of
(street name)

and continuing approximately feet in a direction.
(distance) (compass heading)

Install underground facilities:

Street(s)

Description of Work:

Install pole, down guy, and anchor with an 4ft lead across from pole 9 Woodland Rd. Pole and anchor will be located on town property on the north side of Woodland Rd. Pole will be labeled 9-84.

ENGINEER Prasand Nair

DATE 5/5/17

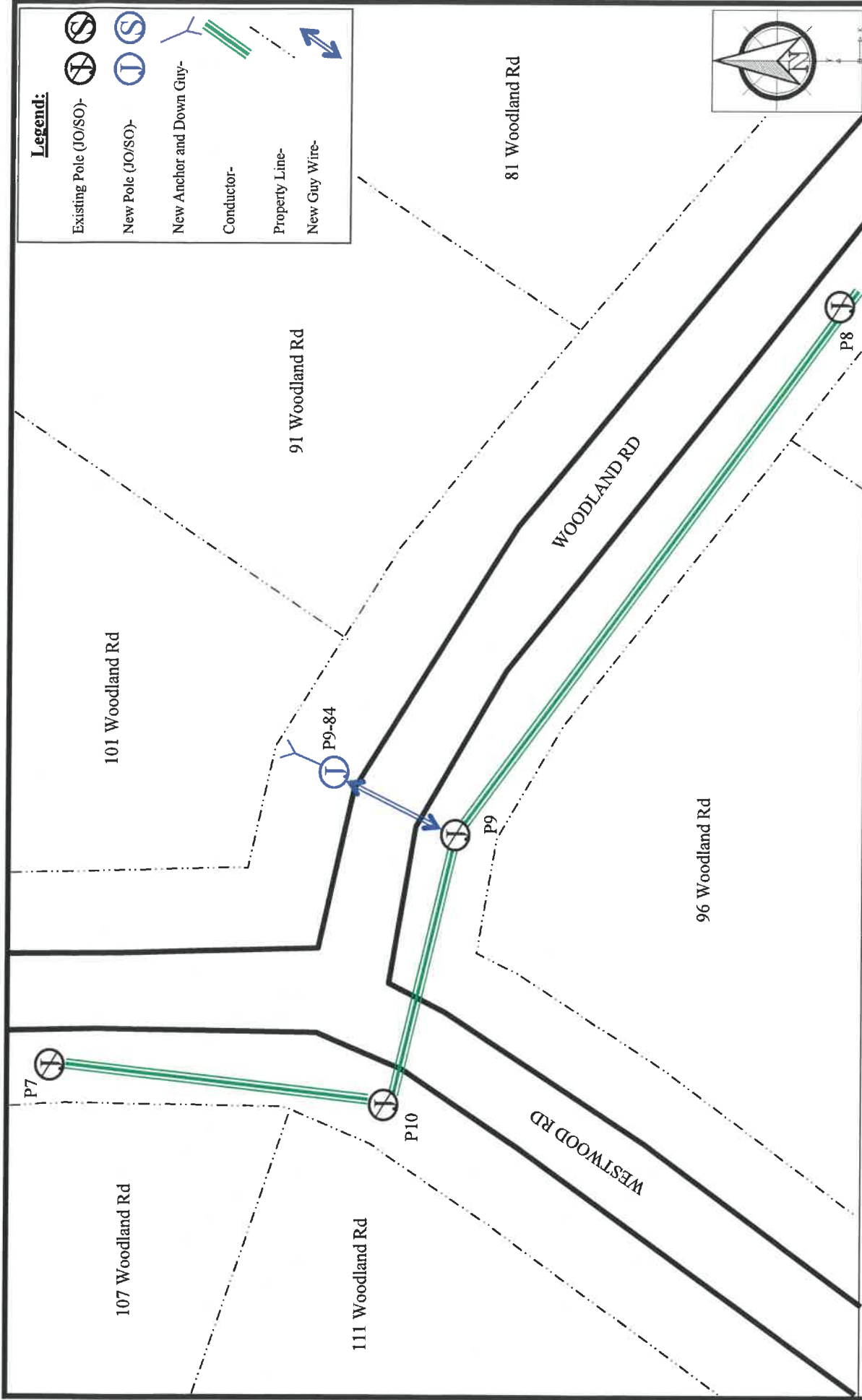

Petition #:	Petition Sketch	nationalgrid
Designer: Prasad Nair Date: 5/5/17 Work Order #: 23988314 Town: Wrentham, MA	CONSTRUCTION DETAILS: Install 35ft class 3 pole, down guy, and anchor with an 4ft lead across from pole 9 Woodland Rd. Pole and anchor will be located on town property on the north side of Woodland Rd. Pole will be labeled 9-84.	Exhibit A-Not to Scale The Exact location of said Facilities to be established by and upon the installation and erection of the Facilities thereof